

CONSTRUCTION DRAWINGS EAST SOIL STOCKPILE WASTE MANAGEMENT OF NEW HAMPSHIRE, INC. ROCHESTER, NEW HAMPSHIRE MARCH 2021 LAST REVISED JULY 2021

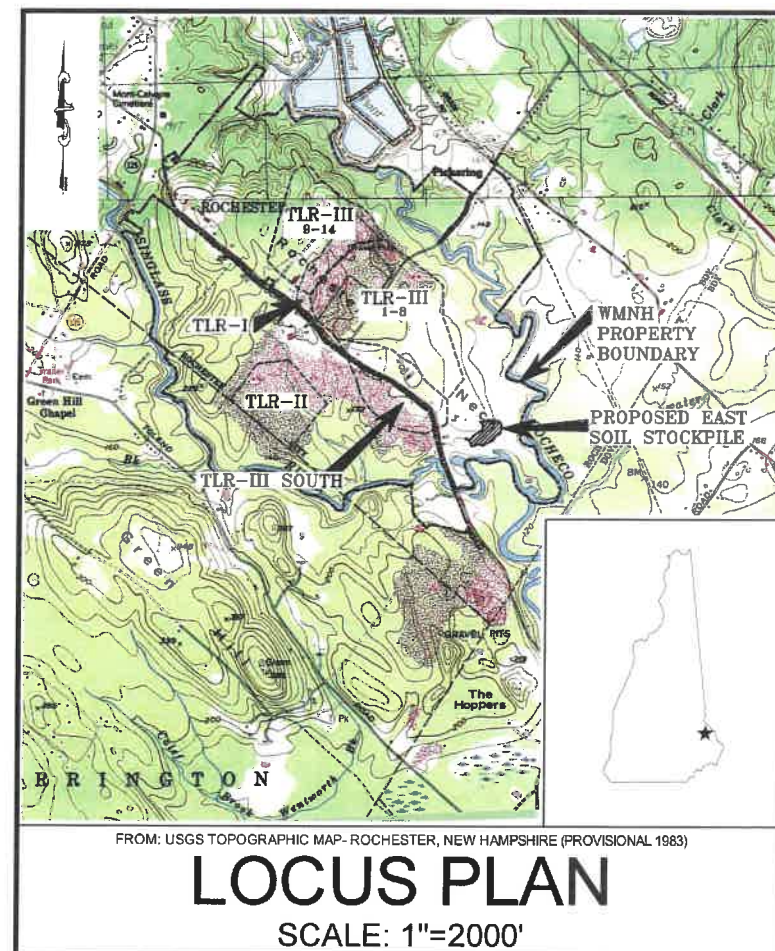
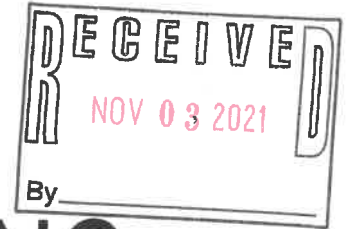

SHEET INDEX

SHEET NO.	TITLE
1	NOTES, ABBREVIATIONS, AND LEGEND
2	OVERALL SITE PLAN
3	EXISTING CONDITIONS PLAN
4	SITE DEVELOPMENT PLAN
5	EROSION AND SEDIMENT CONTROL NOTES AND DETAILS
6	EAST STOCKPILE POND DETAILS
7	POTENTIAL THREATENED OR ENDANGERED SPECIES FLYERS

FOR MORE INFORMATION ABOUT THESE PLANS, CONTACT THE CITY OF ROCHESTER PLANNING DEPARTMENT, 33 WAKEFIELD STREET, ROCHESTER, NH 03867 (603) 335-1338.

ROCHESTER PLANNING BOARD *approved 5-3-21*
APPROVAL CERTIFIED BY: *Shawn B. Saunders* DATE: *11-8-21*

THE DEVELOPMENT DEPICTED IN THESE DRAWINGS MUST BE IN COMPLIANCE WITH ALL APPLICABLE LAW INCLUDING ALL PERTINENT PROVISIONS OF THE "CITY OF ROCHESTER SITE PLAN REGULATIONS" - UNLESS OTHERWISE WAIVED.

REVISION TABLE			
NO.	DATE	DESCRIPTION	BY
1	07/09/21	REVISED TO ADDRESS NH FISH AND GAME COMMENTS	SAP
2	06/01/21	REVISED TO ADDRESS NH FISH AND GAME COMMENTS	KMA

- NOT FOR CONSTRUCTION -



PREPARED FOR:



WASTE MANAGEMENT OF NEW HAMPSHIRE, INC.
14 TAYLOR AVENUE, ROCHESTER, NEW HAMPSHIRE

PREPARED BY:

SANBORN HEAD

20 FOUNDRY STREET, CONCORD, NEW HAMPSHIRE 03301
(603) 229-1900 FAX (603) 229-1919

© 2021 SANBORN HEAD & ASSOCIATES, INC.
MADE IN THE UNITED STATES OF AMERICA
PROJECT: PLANNING BOARD APPROVAL FOR WASTE MANAGEMENT OF NEW HAMPSHIRE, INC.
DRAWN BY: S. PERRY
DESIGNED BY: A. MATTHEWS
REVIEWED BY: K. ANDERSON
PROJECT MGR: A. MATTHEWS
PIC: E. STEINHAUSER
DATE: MARCH 2021
FOR MORE INFORMATION ABOUT THESE PLANS, CONTACT THE CITY OF ROCHESTER PLANNING DEPARTMENT, 33 WAKEFIELD STREET, ROCHESTER, NH 03667 (603) 335-1336.
SCALE: AS NOTED
SHEET NUMBER: 1 OF 7

REFERENCE NOTES

- THE EXISTING TOPOGRAPHY AND SITE FEATURES PRESENTED ON THESE DRAWINGS REPRESENT THE ANTICIPATED CONDITIONS AT THE START OF CONSTRUCTION AND ARE BASED ON THE ONGOING TLR-II SOUTH AREA INITIAL CONSTRUCTION PROJECT AND THE RESOURCES LISTED BELOW. THE SITE TOPOGRAPHY AND SITE FEATURES MAY BE DIFFERENT AT THE TIME OF CONSTRUCTION.
- EXISTING TOPOGRAPHY AND SITE FEATURES WERE PROVIDED TO SANBORN HEAD IN AN ELECTRONIC FILE TITLED, "30900206-001-1-2020_MAPPING-REV1.dwg" PREPARED FROM AERIAL PHOTOGRAMMETRIC METHODS BY WSP USA INC. OF MERRIMACK, NEW HAMPSHIRE FOR WASTE MANAGEMENT OF NEW HAMPSHIRE, INC. (WMNH) USING AERIAL PHOTOGRAPHY DATED APRIL 23, 2020 AT AN ORIGINAL SCALE OF 1" = 100' AND CONTOUR INTERVAL OF 2 FEET. VERTICAL DATUM IS BASED ON NGVD 1929. HORIZONTAL DATUM IS BASED ON NEW HAMPSHIRE STATE PLANE COORDINATE SYSTEM NAD 1983 (US SURVEY FEET).
- VERTICAL DATUM IS BASED ON NGVD 1929. GRID IS BASED ON NEW HAMPSHIRE STATE PLANE COORDINATE SYSTEM NAD 1983.
- WETLANDS SHOWN REPRESENT A COMPILATION OF INFORMATION OBTAINED USING EXISTING AERIAL PHOTOGRAPHY, SOILS INFORMATION, U.S.F.W.S. NATIONAL WETLAND INVENTORY MAPS, AND DELINEATIONS PERFORMED IN OCTOBER AND DECEMBER 2014 AND SUPPLEMENTED WITH ADDITIONAL DELINEATIONS PERFORMED BETWEEN SEPTEMBER 2000 AND JUNE 2015 BY BARRY H. KEITH, NH CWS #087, IN ACCORDANCE WITH NHWB ADMINISTRATIVE RULE WT 301.01 (A-C) USING THE METHODS OUTLINED IN THE CORPS OF ENGINEERS WETLAND DELINEATION MANUAL, TECHNICAL REPORT Y-87-1 (JANUARY 1987) AND FIELD IDENTIFYING HYDRIC SOILS IN NEW ENGLAND (VERSION II) PUBLISHED BY THE N.E. INTERSTATE WATER POLLUTION CONTROL COMMISSION. WETLAND AREAS WERE CLASSIFIED IN ACCORDANCE WITH NHWB ADMINISTRATIVE RULE WT 301.02 USING THE USFWS/OBS-79/31 MANUAL CLASSIFICATION OF WETLANDS AND DEEPWATER HABITATS OF THE UNITED STATES (COWARDIN ET AL, 1979).
- THE 100-YEAR AND 500-YEAR FLOODPLAINS ARE BASED ON INFORMATION PROVIDED ON THE FEDERAL EMERGENCY MANAGEMENT AGENCY (FEMA) "FLOOD INSURANCE RATE MAP, STRAFFORD COUNTY, NEW HAMPSHIRE" PANEL 302 OF 405, LAST REVISED ON SEPTEMBER 30, 2015.
- PROPERTY LINE INFORMATION WAS TAKEN FROM THE FOLLOWING:
 - A PLAN TITLED, "BOUNDARY COMPILATION AND FOOTPRINT COMPILATION OF TLR-I AND TLR-II, ROCHESTER NECK ROAD, ROCHESTER, NEW HAMPSHIRE" PREPARED FOR WASTE MANAGEMENT OF NEW HAMPSHIRE, INC. BY CHAS. H. SELLS, INC. OF NASHUA, NEW HAMPSHIRE DATED JANUARY 29, 2002 AT A SCALE OF 1" = 300'.
 - A PLAN TITLED, "PLAN OF LAND, 36 ROCHESTER NECK ROAD, ROCHESTER, NEW HAMPSHIRE (MAP 262, LOT 23)" PREPARED BY WSP USA, INC. OF NASHUA, NEW HAMPSHIRE DATED OCTOBER 2, 2018 AT A SCALE OF 1" = 80'.
 - ELECTRONIC (AUTOCAD) TAX MAP FILES CREATED BY CAI TECHNOLOGIES OF LITTLETON, NEW HAMPSHIRE.
 - PLANS TITLED "ROCHESTER NECK ROAD DISCONTINUANCE PLAN" AND "ROCHESTER NECK ROAD RELOCATION," BOTH DATED SEPTEMBER 29, 2020, PREPARED FOR WMNH BY WSP USA, INC. OF MERRIMACK, NH.
 - A PLAN TITLED "PROPOSED CONDITIONS PLAN, PARCELS 267-3 & 267-4 LOT LINE REVISION," DATED AUGUST 2020 AND REVISED OCTOBER 2020, PREPARED FOR WMNH BY SANBORN HEAD.
- ZONING INFORMATION IS BASED ON A PLAN TITLED "CITY OF ROCHESTER, ZONING MAP" ADOPTED APRIL 14, 2014 AND LAST AMENDED FEBRUARY 6, 2018.
- THE EXISTING UTILITIES SHOWN ON THESE PLANS DO NOT REPRESENT A COMPLETE COMPILATION OF ALL UTILITIES INSTALLED AT THE SITE. THE CONTRACTOR SHALL COORDINATE WITH WMNH TO REVIEW ALL AS-BUILT DRAWINGS PRIOR TO EXCAVATING. DAMAGE CAUSED TO EXISTING UTILITIES DURING CONSTRUCTION WILL BE REPAIRED PROMPTLY BY THE CONTRACTOR AT NO COST TO WMNH.

DESIGN NOTES

- THE CONTRACTOR IS RESPONSIBLE FOR CONTACTING DIG SAFE PRIOR TO INITIATING EARTHWORK.
- THE CONTRACTOR SHALL COORDINATE WITH WMNH TO REVIEW ALL AS-BUILT DRAWINGS TO LOCATE EXISTING UTILITIES PRIOR TO THE START OF CONSTRUCTION. DAMAGE CAUSED TO EXISTING UTILITIES DURING CONSTRUCTION WILL BE REPAIRED PROMPTLY BY THE CONTRACTOR AT NO COST TO WMNH.
- THE CONTRACTOR IS RESPONSIBLE FOR OBTAINING ALL REQUIRED CONSTRUCTION PERMITS NOT ALREADY OBTAINED BY WMNH.



NATURAL RESOURCES NOTES
(COMPLIES WITH ENV-WQ 1503.19 (H))

- AVOID TREE CLEARING FROM JUNE 1 TO JUNE 30.
- ALL MANUFACTURED EROSION AND SEDIMENT CONTROL PRODUCTS, EXCEPT FOR SILT FENCE INSTALLED IN ACCORDANCE WITH ENV-WQ 1506.04, UTILIZED FOR, BUT NOT LIMITED TO, SLOPE PROTECTION, RUNOFF DIVERSION, SLOPE INTERRUPTION, PERIMETER CONTROL, INLET PROTECTION, CHECK DAMS, AND SEDIMENT TRAPS SHALL NOT CONTAIN WELDED PLASTIC, PLASTIC, OR MULTI-FILAMENT OR MONOFILAMENT POLYPROPYLENE NETTING OR MESH.
- CONTRACTOR SHALL BE AWARE OF THE POTENTIAL FOR RARE, THREATENED AND ENDANGERED SPECIES WITHIN THE PROJECT AREA. SPECIES THAT MAY BE WITHIN THE PROJECT AREA INCLUDE THE NORTHERN BLACK RACER SNAKE, SPOTTED TURTLES, BLANDING'S TURTLES AND WOOD TURTLES. SEE SHEET 7. FOR ADDITIONAL INFORMATION ON IDENTIFICATION. OBSERVATION OF THESE THREATENED OR ENDANGERED SPECIES SHALL BE REPORTED TO NHFG VIA EMAIL TO RAARP@WILDLIFE.NH.GOV AND MELISSA.DOPER@WILDLIFE.NH.GOV. EMAIL SUBJECT LINE: NHB21-0817-EAST SOIL STOCKPILE-Wildlife Observation. PHOTOGRAPHS SHALL BE PROVIDED FOR VERIFICATION AS FEASIBLE. NHFG SHALL BE CONTACTED IMMEDIATELY IF ANY SPECIES ARE OBSERVED TO BE NESTING OR MAY POSSIBLY BE NESTING.
- IF ANY THREATENED OR ENDANGERED SPECIES ARE OBSERVED WITHIN THE DISTURBANCE AREA AND IT IS SAFE TO DO SO, MOVE TO THE CLOSEST LOCATION IN THE DIRECTION THE WERE HEADING AND CONTACT NHFG MELISSA DOPER@WILDLIFE.NH.GOV OR PHONE 603-479-1129 OR CONTACT THE NHFG WILDLIFE ADMINISTRATOR AT 603-271-2481. INCLUDE PHOTOGRAPH AS FEASIBLE.
- NHFG SHALL HAVE ACCESS TO THE PROPERTY DURING THE TERM OF THE PERMIT.
- EASTERN MEADOWLARKS MAY BE FOUND IN THE AREA. IF A NEST IS ENCOUNTERED, PLEASE NOTIFY NHFG IMMEDIATELY. NESTS ARE PROTECTED UNDER STATE AND FEDERAL LAWS. OPEN/GRASSY AREAS THAT WILL BE DISTURBED AS PART OF PROPOSED ACTIVITIES SHALL BE MAINTAINED MOWED PRIOR TO AND THROUGHOUT THE NESTING SEASON TO DETOUR NESTING ACTIVITIES BY BIRDS.
- NO PESTICIDES SHALL BE USED IN LANDSCAPING.
- ALL TEMPORARY DISTURBED AREAS OUTSIDE THE LIMITS OF DEVELOPMENT WITH SHALL BE REVEGETATED WITH GRASS.
- EXISTING LAND USE WITHIN THE 250' SHORELAND AND 100' 500 YEAR FLOODPLAIN SETBACKS SHALL BE MAINTAINED.

CONSTRUCTION SEQUENCE

THE FOLLOWING SCHEDULE IS NOT INTENDED TO PRESENT A DETAILED REPRESENTATION OF THE WORK TO BE PERFORMED BY THE CONTRACTOR. THE FOLLOWING SCHEDULE OUTLINES THE SIGNIFICANT ASPECTS OF THE PROJECT IN AN ORDER THAT SHOULD BE CONSIDERED BY THE CONTRACTOR WHEN SCHEDULING THE WORK. THE ACTUAL SCHEDULE AND ORDER OF WORK SHALL BE DEVELOPED BY THE CONTRACTOR AND SUBMITTED TO THE ENGINEER AND WMNH FOR REVIEW AND APPROVAL. THE SCHEDULE SHALL BE BASED ON THE PROJECT COMPONENTS, AS DEFINED IN THE DRAWINGS AND SPECIFICATIONS AND INTENDED TO COMPLY WITH ALL LOCAL, STATE, AND FEDERAL REQUIREMENTS.

- MOBILIZE TO SITE AND ESTABLISH VERTICAL AND HORIZONTAL CONTROL FOR THE PROJECT.
- INSTALL EROSION AND SEDIMENT CONTROL MEASURES, AND INSTALL CONSTRUCTION FENCE ALONG LIMIT OF DISTURBANCE.
- CLEAR AND GRUB, STRIP AND STOCKPILE TOPSOIL.
- CONSTRUCT EAST SOIL STOCKPILE BASIN AND OUTLET STRUCTURE.
- PLACE SOIL IN STOCKPILE AREA.
- CONSTRUCT SIDE SLOPE SWALES AS SOIL IS PLACED TO GRADE.
- REMOVE EROSION CONTROLS ONCE SLOPES ARE STABILIZED.
- PREPARE AS-BUILT DRAWINGS.
- DEMOBILIZE FROM THE SITE.

ABBREVIATIONS

Ø	DIAMETER	MRF	MATERIALS RECOVERY FACILITY
%	PERCENT	N	NORTHING, NORTH
CMP	CORRUGATED METAL PIPE	OD	OUTER DIAMETER
CPP	CORRUGATED POLYETHYLENE PIPE	OZ/YD	OUNCE PER SQUARE YARD
DMH	DRAIN MANHOLE	PVC	POLYVINYL CHLORIDE
E	EASTING, EAST	REQD	REQUIRED
EL.	ELEVATION	SCH	SCHEDULE
GA.	GAUGE	S	SOUTH
HDPE	HIGH DENSITY POLYETHYLENE	STA	STATION
INV	INVERT	SQ	SQUARE
MAX	MAXIMUM	SY	SQUARE YARD
MIN	MINIMUM	TLR	TURNKEY LANDFILL OF ROCHESTER
		TYP	TYPICAL
		W	WEST

LEGEND

EXISTING CONDITIONS

-----	LIMIT OF WASTE CONTAINMENT
-----	TLR-IIS PERMITTED LIMIT OF DISTURBANCE
-----	PROPERTY LINE
.....	TLR-I LIMIT OF WASTE CONTAINMENT
-----	2-FOOT ELEVATION CONTOUR
-----	10-FOOT ELEVATION CONTOUR
-----	EDGE OF ROAD
-----	UNPAVED ROAD
-----	LIMIT OF WETLANDS
-----	EDGE OF WATER
-----	FENCE
-----	TREE LINE
-----	GUARDRAIL
----- NG ----- NG -----	NATURAL GAS LINE
----- OE ----- OE -----	OVERHEAD ELECTRIC
-----	DRAINAGE CULVERT
-----	WETLAND AREA
-----	RIPRAP-LINED SWALE
-----	PAVEMENT
-----	UTILITY POLE
-----	POST
-----	MISC. OBJECT
-----	SIGN
-----	LIGHT POST
-----	TREE/BUSH

PROPOSED CONDITIONS

-----	LIMIT OF DISTURBANCE
-----	SLOPE BREAK
----- 182 -----	2-FOOT ELEVATION CONTOUR
----- 180 -----	10-FOOT ELEVATION CONTOUR
-----	EDGE OF GRAVEL
-----	SEDIMENT FILTER LOG
----- D ----- D -----	DRAINAGE CULVERT
-----	TREE LINE
-----	RIPRAP
-----	SLOPE AND DIRECTION
-----	SPOT ELEVATION

2.0%

159.00

X

FOR MORE INFORMATION ABOUT THESE PLANS, CONTACT THE CITY OF ROCHESTER PLANNING DEPARTMENT, 33 WAKEFIELD STREET, ROCHESTER, NH 03667 (603) 335-1336.

ROCHESTER PLANNING BOARD
APPROVAL CERTIFIED BY:

DATE:

SANBORN HEAD

SCALE: AS NOTED



NO.	DESCRIPTION	BY
7/9/21	REVISED NOTES TO ADDRESS NH FISH AND GAME COMMENTS	SAP
6/1/21	REVISED NOTES TO ADDRESS NH FISH AND GAME COMMENTS	KMA

DRAWN BY: S. PERRY
DESIGNED BY: A. MATTHEWS
REVIEWED BY: K. ANDERSON
PROJECT MGR: A. MATTHEWS
PIC: E. STEINHAUSER
DATE: MARCH 2021

CONSTRUCTION DRAWINGS
EAST SOIL STOCKPILE
WASTE MANAGEMENT OF NEW HAMPSHIRE, INC.
ROCHESTER, NEW HAMPSHIRE

PROJECT NUMBER:

3534.07

NOTES, ABBREVIATIONS, AND LEGEND

SHEET NUMBER:

1 OF 7

- NOT FOR CONSTRUCTION -

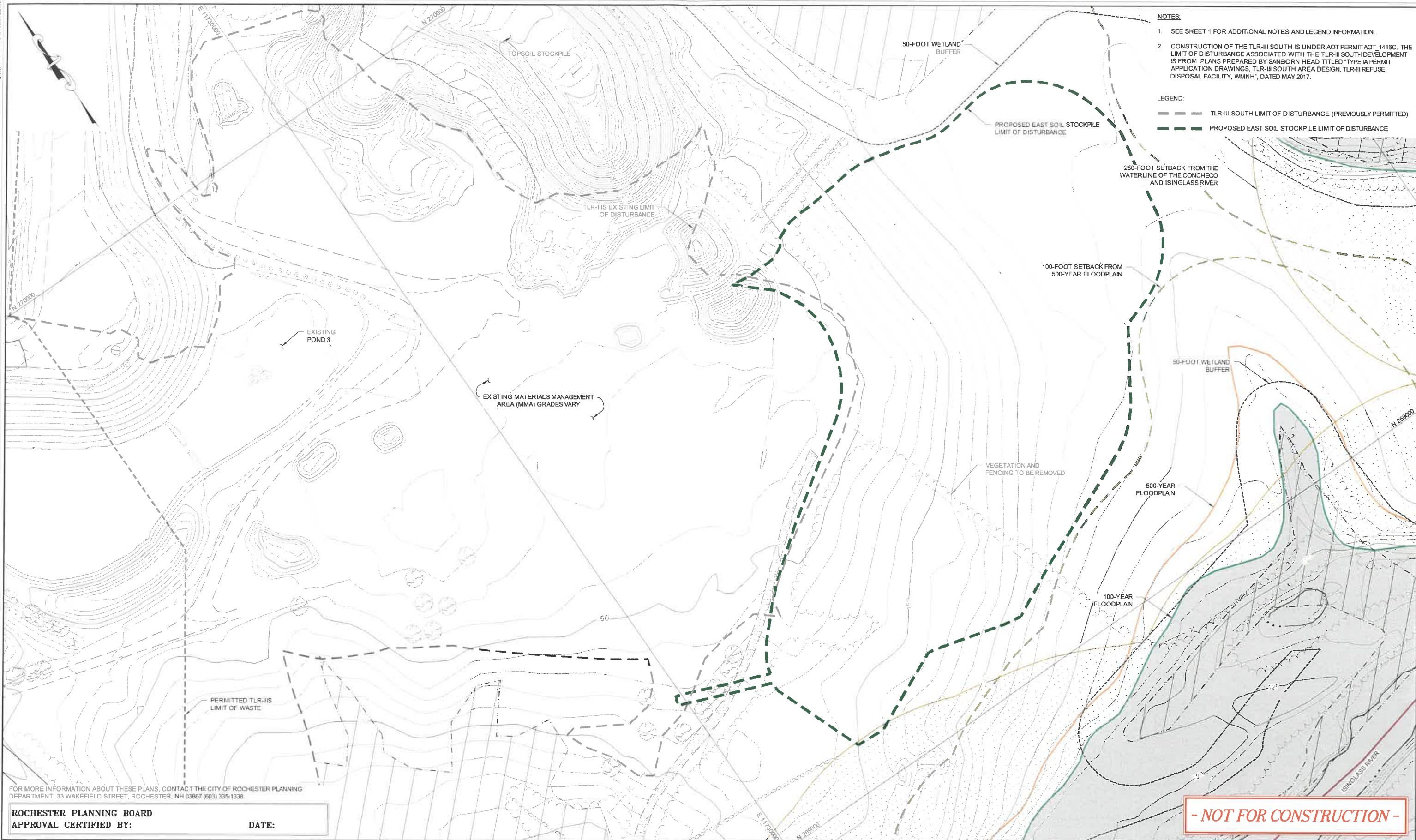
[illegible]

FOR MORE INFORMATION ABOUT THESE PLANS, CONTACT THE CITY OF ROCHESTER PLANNING DEPARTMENT, 33 WAKEFIELD STREET, ROCHESTER, NH 03867 (603) 335-1338.

ROCHESTER PLANNING BOARD
APPROVAL CERTIFIED BY:

DATE:

SANBORN HEAD

[illegible]







DRAWN BY: S. PERRY
DESIGNED BY: A. MATTHEWS / E. GALVIN
REVIEWED BY: K. ANDERSON
PROJECT MGR: A. MATTHEWS
PIC: E. STEINHAUSER
DATE: MARCH 2021

CONSTRUCTION DRAWINGS
EAST SOIL STOCKPILE
WASTE MANAGEMENT OF NEW HAMPSHIRE, INC.
ROCHESTER, NEW HAMPSHIRE

EXISTING CONDITIONS PLAN

PROJECT NUMBER:	3534.07
SHEET NUMBER:	3 OF 7

1. EXISTING TOPOGRAPHY AND SITE FEATURES WERE PROVIDED TO SANBORN HEAD IN AN ELECTRONIC FILE TITLED, "30900206-001-1-2020, MAPPING-REV1.dwg" PREPARED FROM AERIAL PHOTOGRAMMETRIC METHODS BY WSP USA INC. OF MERRIMACK, NEW HAMPSHIRE FOR WASTE MANAGEMENT OF NEW HAMPSHIRE, INC. (WMNH) USING AERIAL PHOTOGRAPHY DATED APRIL 23, 2020 AT AN ORIGINAL SCALE OF 1" = 100' AND CONTOUR INTERVAL OF 2 FEET. VERTICAL DATUM IS BASED ON NGVD 1929. HORIZONTAL DATUM IS BASED ON NEW HAMPSHIRE STATE PLANE COORDINATE SYSTEM NAD 1983 (US SURVEY FEET).
2. WETLAND AREAS REPRESENT A COMPILATION OF INFORMATION DETERMINED USING EXISTING AERIAL PHOTOGRAPHY, SOILS INFORMATION, U.S.F.W.S. NATIONAL WETLAND INVENTORY MAPS AND DELINEATIONS CONDUCTED BY BARRY H. KEITH AT VARIOUS TIMES FROM SEPTEMBER OF 2000 UNTIL SEPTEMBER OF 2015, NH CWS #087, IN ACCORDANCE WITH NHWB ADMINISTRATIVE RULE WT 301.01 (A-C) USING THE METHODS OUTLINED IN THE CORPS OF ENGINEERS WETLAND DELINEATION MANUAL, TECHNICAL REPORT Y-87-1 (JANUARY 1987), AND FIELD IDENTIFYING HYDRIC SOILS IN NEW ENGLAND (VERSION II) PUBLISHED BY THE N.E. INTERSTATE WATER POLLUTION CONTROL COMMISSION. WETLAND FLAGS WERE SURVEYED BY CHAS H. SELLS OF NASHUA, NEW HAMPSHIRE. WETLAND AREAS WERE CLASSIFIED IN ACCORDANCE WITH NHWB ADMINISTRATIVE RULE WT 301.02 USING THE USFWS/BS-79/31 MANUAL CLASSIFICATION OF WETLANDS AND DEEPWATER HABITATS OF THE UNITED STATES (COWARD ET AL., 1979).
3. THE 100-YEAR AND 500-YEAR FLOODPLAINS ARE BASED ON INFORMATION PROVIDED ON THE FEDERAL EMERGENCY MANAGEMENT AGENCY (FEMA) "FLOOD INSURANCE RATE MAP, STAFFORD COUNTY, NEW HAMPSHIRE" PANEL 302 OF 405, LAST REVISED ON SEPTEMBER 30, 2015

- LEGEND:
- | | |
|---|--|
|  | PROPERTY LINE |
|  | DELINEATED WETLAND |
|  | RECYCLING INDUSTRIAL |
|  | TLR-III SOUTH LIMIT OF DISTURBANCE
(PREVIOUSLY PERMITTED) |
|  | PROPOSED EAST SOIL STOCKPILE
LIMIT OF DISTURBANCE |
|  | SEDIMENT FILTER LOG |
|  | ZONE JURISDICTIONAL WETLAND |

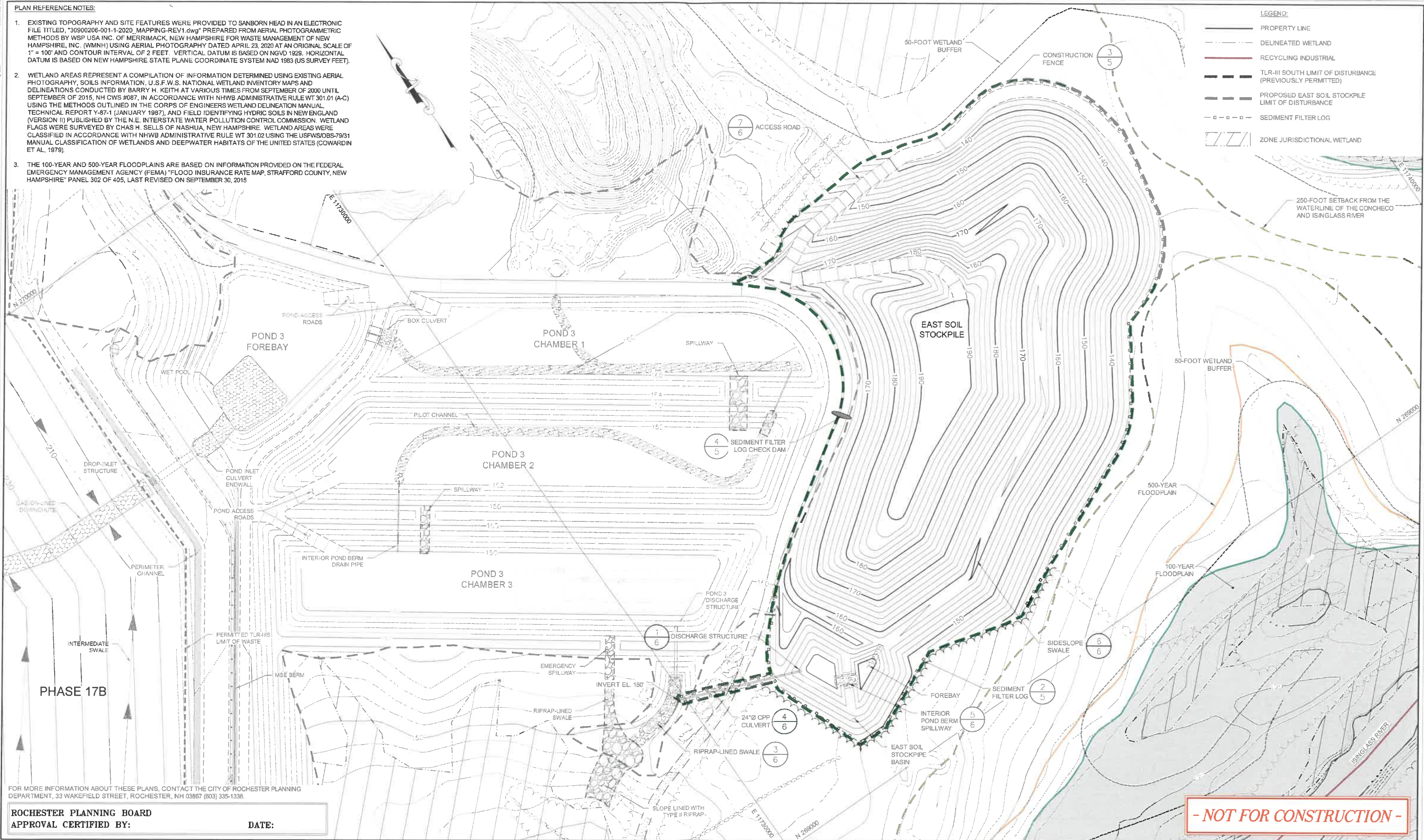

FOR MORE INFORMATION ABOUT THESE PLANS, CONTACT THE CITY OF ROCHESTER PLANNING DEPARTMENT, 33 WAKEFIELD STREET, ROCHESTER, NH 03867 (603) 335-1338.

ROCHESTER PLANNING BOARD
APPROVAL CERTIFIED BY:

DATE:

- NOT FOR CONSTRUCTION -

SANBORN HEAD

[illegible]

DRAWN BY: S. PERRY
DESIGNED BY: A. MATTHEWS / E. GALVIN
REVIEWED BY: K. ANDERSON
PROJECT MGR: A. MATTHEWS
PIC: E. STEINHAUSER
DATE: MARCH 2021

CONSTRUCTION DRAWINGS
EAST SOIL STOCKPILE
WASTE MANAGEMENT OF NEW HAMPSHIRE, INC.
ROCHESTER, NEW HAMPSHIRE

SITE DEVELOPMENT PLAN

PROJECT NUMBER:
3534.07

SHEET NUMBER:
4 OF 7

PROJECT NUMBER:	3534.07
SHEET NUMBER:	5 OF 7



NOT TO SCALE

ANCHORING
(ELEVATION VIEW)

- NOT FOR CONSTRUCTION -

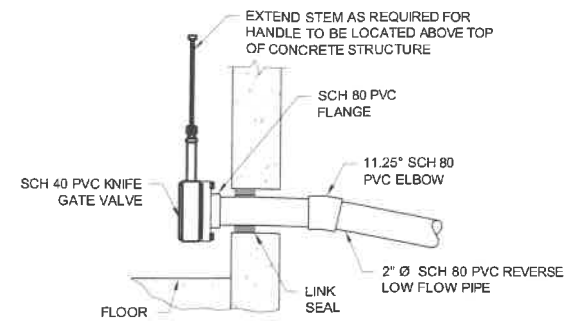

2 _____
NOT TO SCALE

Figure 1 is a cross-sectional diagram of a riprap-lined ditch. The ditch has a central bed of riprap and sloped sides. A layer of "TOPSOIL AND SEED" (1 inch thick) is on the surface. Below it is a "10-oz/yd² NONWOVEN GEOTEXTILE". The riprap bed is 2 inches thick. The Type I riprap on the slopes is 12 inches thick. The ditch width is 3 feet. A circular inset shows a 1/5 ratio.

3 NOT TO SCALE (TRAPEZOIDAL)



6 NOT TO SCALE

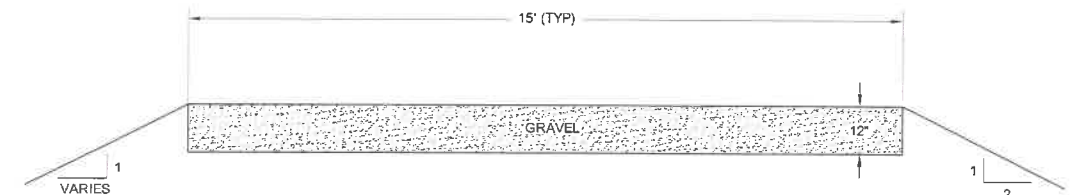

7 NOT TO SCALE

NO.	DESCRIPTION	B
-----	-------------	---

6 OF 7

- NOT FOR CONSTRUCTION -



PLEASE REPORT OBSERVATIONS OF RARE TURTLES

The NH Fish & Game Department is requesting
observations of the following turtle species



Blanding's turtle
(State Endangered)

Large, dark/black domed shell
with lighter speckles.

Distinct yellow throat/chin.

Aquatic but often moves on land.



Spotted turtle
(State Threatened)

Small, mostly aquatic with
black or dark brown with
yellow spots.

Fairly flat shell compared
to Blanding's turtle.

Spots vary in color and
number.

Report sightings immediately to NHFG Wildlife Division at 603-271-2461 (M-F 8-4) or to
NHFG Wildlife Biologist Melissa Doperalski 603-479-1129 (cell) anytime.
Please report promptly, noting specific location and date -- Photographs strongly encouraged



Northern Black Racer

(New Hampshire state threatened species)



- Solid black with a white throat
and chin
- Slender with glossy scales, 3-6 ft.
long
- Hatchlings are very small and
patterned



Immediately report sightings to NH Fish and Game
Melissa Doperalski (603-419-1129) or
Brendan Clifford (603-944-0885)

*Please report promptly, noting specific location and date
Photographs strongly encouraged*



Wood Turtle

(*Glyptemys insculpta*)

(New Hampshire Species of Special Concern)



- Neck and forelimbs are
orange.
- Characterized by its highly
sculpted shell with each
large scute taking on an
irregular pyramidal shape.
- Adults can be 5-8 inches
long.



Please report sightings to NH Fish and Game at
RAARP@wildlife.nh.gov or at 603-271-2461. Photo documentation,
location, and date/time of observation is helpful.

**NOTE: It is illegal to remove a wood turtle from the wild (RSA 207:1,
FIS 804.02).**

FOR MORE INFORMATION ABOUT THESE PLANS, CONTACT THE CITY OF ROCHESTER PLANNING
DEPARTMENT, 33 WAKEFIELD STREET, ROCHESTER, NH 03867 (603) 335-1338.

ROCHESTER PLANNING BOARD
APPROVAL CERTIFIED BY:

DATE:

- NOT FOR CONSTRUCTION -

SANBORN HEAD

SCALE: AS NOTED



NO.	DESCRIPTION	BY
7/9/21	REVISED NOTES TO ADDRESS NH FISH AND GAME COMMENTS	SAP

DRAWN BY: S. PERRY
DESIGNED BY: A. MATTHEWS
REVIEWED BY: K. ANDERSON
PROJECT MGR: A. MATTHEWS
PIC: E. STEINHAUSER
DATE: MARCH 2021

CONSTRUCTION DRAWINGS
EAST SOIL STOCKPILE
WASTE MANAGEMENT OF NEW HAMPSHIRE, INC.
ROCHESTER, NEW HAMPSHIRE

POTENTIAL THREATENED OR
ENDANGERED SPECIES FLYERS

PROJECT NUMBER:

3534.07

SHEET NUMBER:

7 OF 7